

RECOMMEND P.C.B LAYOUT
GENERAL TOLERANCE ± 0.05

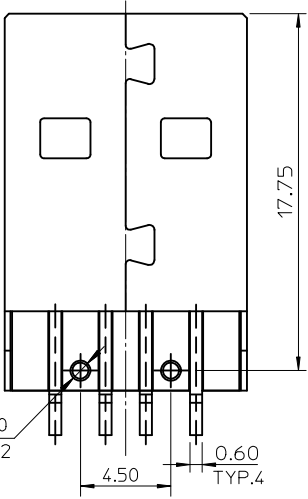
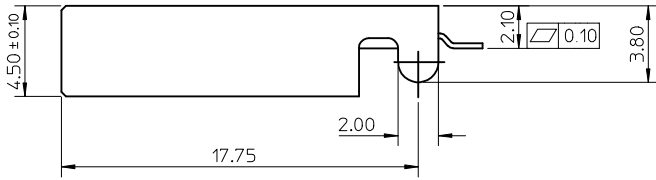
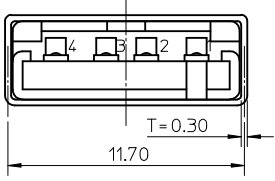
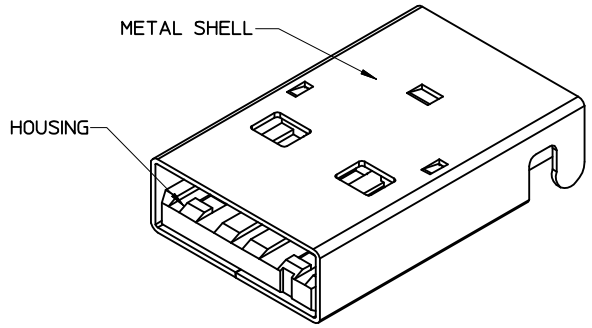

- NOTES:
- MATERIAL:
HOUSING: NYLON 46, GLASS FIBER FILLED, UL94V-0, COLOR: BLACK.
SHELL: COLD ROLLED STEEL.
TERMINAL: BRASS.
 - FINISH:
TERMINAL:
SELECTIVE GOLD(Au) IN CONTACT AREA, THICKNESS=30 MICROINCH MINIMUM;
SELECTIVE TIN(Sn) IN SOLDER TAIL AREA, THICKNESS=120 MICROINCH MINIMUM;
NICKEL(Ni) OVERALL.
METAL SHELL:
NICKEL(Ni) OVERALL,
UNDER PLATED: COPPER(Cu) OVERALL, THICKNESS=50 MICROINCH MINIMUM.
 - RECOMMENDED PCB THICKNESS: 1.6mmY±0.05.
 - PRODUCT SPECIFICATION REFERS TO PS-48037-001.
 - PACKAGE SPECIFICATION REFERS TO PK-48037-210.
 - TEST SUMMARY REFERS TO TS-48037-001.
 - COPLANARITY TO BE 0.10mm MAX.
 - LEAD FREE AND RoHS COMPLIANT PRODUCT.
 - DATE CODE:
X X X X X
YEAR WEEK DAY

REVISED IEC NO: SH2009-0435 DRWN: LWZHOU 2008/12/29 CH'KD: QMZHANG02 2008/12/29 APPR: HMWANG 2009/01/09	QUALITY SYMBOLS	GENERAL TOLERANCES (UNLESS SPECIFIED)		DIMENSION STYLE	SCALE	DESIGN UNITS	THIRD ANGLE PROJECTION	
	▽=0 ∇=0	mm	INCH	MM ONLY	3:1	METRIC		
		4 PLACES ± --- ± ---	3 PLACES ± --- ± ---	2 PLACES ± 0.25 ± ---	1 PLACE ± 0.25 ± ---	DRAWN BY DATE TITLE		
		ANGULAR ± 3 °			TOM 2006/02/15 CHECKED BY DATE ROGER TSAI 2006/02/15 APPROVED BY DATE ALLEN LIN 2006/02/15 MATERIAL NO. 48037-2200 DOCUMENT NO. SD-48037-004			
	DRAFT WHERE APPLICABLE MUST REMAIN WITHIN DIMENSIONS			SIZE	THIS DRAWING CONTAINS INFORMATION THAT IS PROPRIETARY TO MOLEX INCORPORATED AND SHOULD NOT BE USED WITHOUT WRITTEN PERMISSION			
				A3	MOLEX INCORPORATED			
					SHEET NO. 1 OF 1			