

15 14 13 12 11 10 9 8 7 6 5 4 3 2 1

DRAWING NUMBER 100-290-250-100	ISSUE 1
PART NUMBER SEE TABLE	

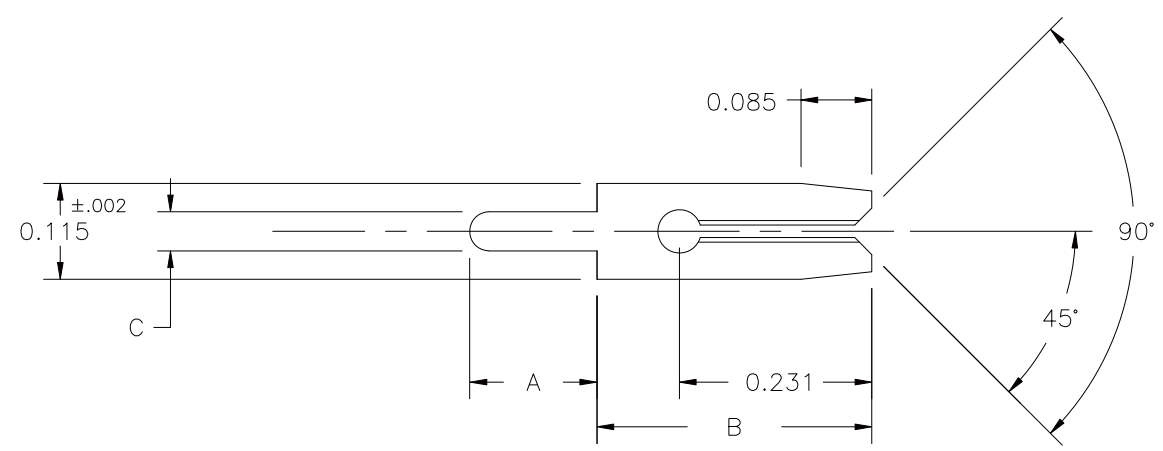

CODE	PART NUMBER	A ±.005	B ±.005	C $\begin{matrix} +.000 \\ -.004 \end{matrix}$
450	100-290-450-100	.182	.330	.047
350	100-290-350-100	.153	.330	.047
250	100-290-250-100	.122	.330	.047
260	100-290-260-100	.122	.330	.047

NOTES:

1- MATERIAL:  $\pm.0005$  .0260 THICK PHOSPHOR BRONZE, GOLD PLATED OVER NICKEL

ACAD REFERENCE NO. 100-290-250-100
---------------------------------------

RECOMMENDED  
DISPOSITION OF STOCK  
(PRIOR ISSUE PARTS)  
 SCRAP  INSPECT  
 REWORK  USE AS IS  
 SEE ENGINEERING MEMO

ISSUE NUMBER

ORIGINAL ①

TOLERANCE UNLESS NOTED	
DIMENSION	TOLERANCE
.00	± .
.000	± .005
.0000	± .
ANGULAR	± 1/2°

P.C. VARICON CONTACT  
BOARD TO BOARD STAND OFF TYPE

DRAWING NOTES:  
1) DO NOT SCALE DRAWING.  
2) DIMENSIONS ARE IN INCHES AND INCLUDE THICKNESS OF PLATING.  
3) ALL SCREW THREADS TO BE CLASS 2 FIT (AM.STD.) UNLESS OTHERWISE SPECIFIED.

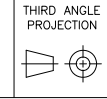

DRAWN: F.BRIONES	DATE: FEB.27/97
CHECKED:	DATE:
ENG.APPR:	DATE:

**EDAC** EDAC INC  
TORONTO, ONTARIO  
CANADA  
YOUR CONNECTION TO QUALITY & SERVICE

THESE DRAWINGS AND SPECIFICATIONS ARE THE PROPERTY OF EDAC INC. AND SHALL NOT BE REPRODUCED OR COPIED OR USED AS THE BASIS FOR THE MANUFACTURE OR SALE OF APPARATUS WITHOUT WRITTEN PERMISSION.

SCALE:	SHEET 1 OF 1
DRAWING NUMBER 100-290-250	ISSUE 1

15 14 13 12 11 10 9 8 7 6 5 4 3 2 1